

T

TITONI

WINDOW SYSTEMS



HS38 SEAMLESS

A NEW ERA FOR
HURRICANE FENESTRATIONS



**ENGINEERED FOR
STRENGTH, ELEGANCE,
AND INNOVATION**



HS38 SEAMLESS

The first of its kind, the TITONI SEAMLESS set the standard for Miami-Dade hurricane testing and redefined the category of invisible flush-track doors. Its hidden sill track design allows flooring to run seamlessly from inside to outside, delivering an unmatched minimal frame aesthetic.

At a certified water pressure of 10.65 PSF, the HS38 SEAMLESS remains the highest-performing invisible flush track on the market. Engineered for strength, elegance, and innovation, it continues to raise the bar in performance and design.



PERFORMANCE DATA (+ 65 / - 65 PSF)

DESIGN PRESSURE RATING	+ 65 / - 65 PSF
INTERLOCK SIGHTLINE	1 1/4"
STRUCTURAL OVERLOAD TESTING	+ / - 105 PSF
WATER PENETRATION RESISTANCE	10.65 PSF
AAMA PERFORMANCE CLASS	CW - PG70
TESTING APPLICATION STANDARDS	TAS 201/202/203
ADDITIONAL TESTING METHODS	ASTM E283/E330/E331/E987/E2608/F842
FLORIDA APPROVAL NUMBERS	41586
APPROVED FOR USE IN HVHZ	YES
APPROVED FOR USE OUTSIDE HVHZ	YES
IMPACT RESISTANT	YES
MISSILE LEVEL	D
WIND ZONE	ZONE 4 & HVHZ
LARGE MISSILE IMPACT RATING	YES
SMALL MISSILE IMPACT RATING	YES
NFRC TESTED AND CERTIFIED	YES

PERFORMANCE DATA (+ 70 / - 70 PSF)

DESIGN PRESSURE RATING	+ 70 / - 70 PSF
INTERLOCK SIGHTLINE	3/4"
STRUCTURAL OVERLOAD TESTING	+ / - 105 PSF
WATER PENETRATION RESISTANCE	10.65 PSF
AAMA PERFORMANCE CLASS	LC - PG70
TESTING APPLICATION STANDARDS	TAS 201/202/203
ADDITIONAL TESTING METHODS	ASTM E283/E330/E331/E987/E2608/F842
FLORIDA APPROVAL NUMBERS	41586
APPROVED FOR USE IN HVHZ	YES
APPROVED FOR USE OUTSIDE HVHZ	YES
IMPACT RESISTANT	YES
MISSILE LEVEL	D
WIND ZONE	ZONE 4 & HVHZ
LARGE MISSILE IMPACT RATING	YES
SMALL MISSILE IMPACT RATING	YES
NFRC TESTED AND CERTIFIED	YES

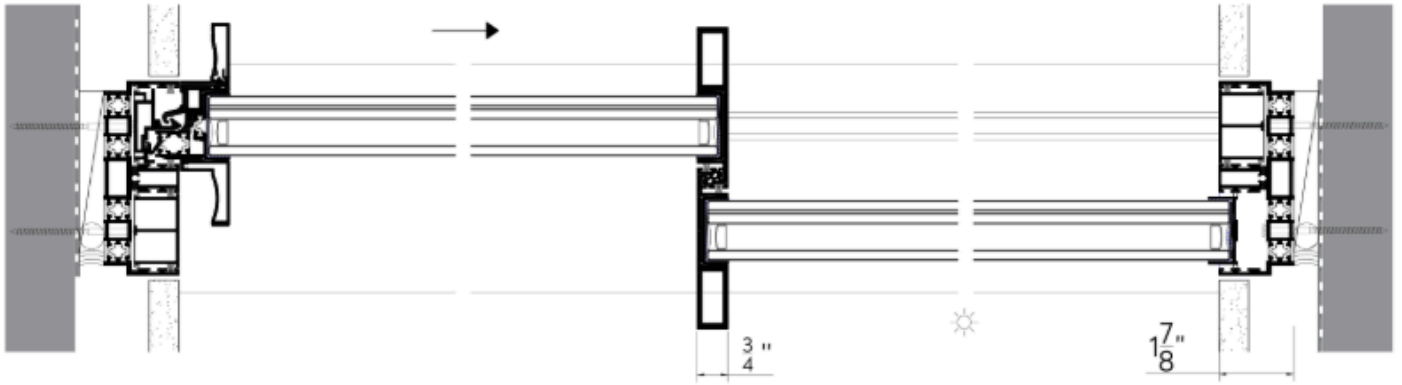

HS38 SEAMLESS
 HURRICANE RATED SLIDING DOOR, PANELS UP TO 4' X 10' AT A DP70

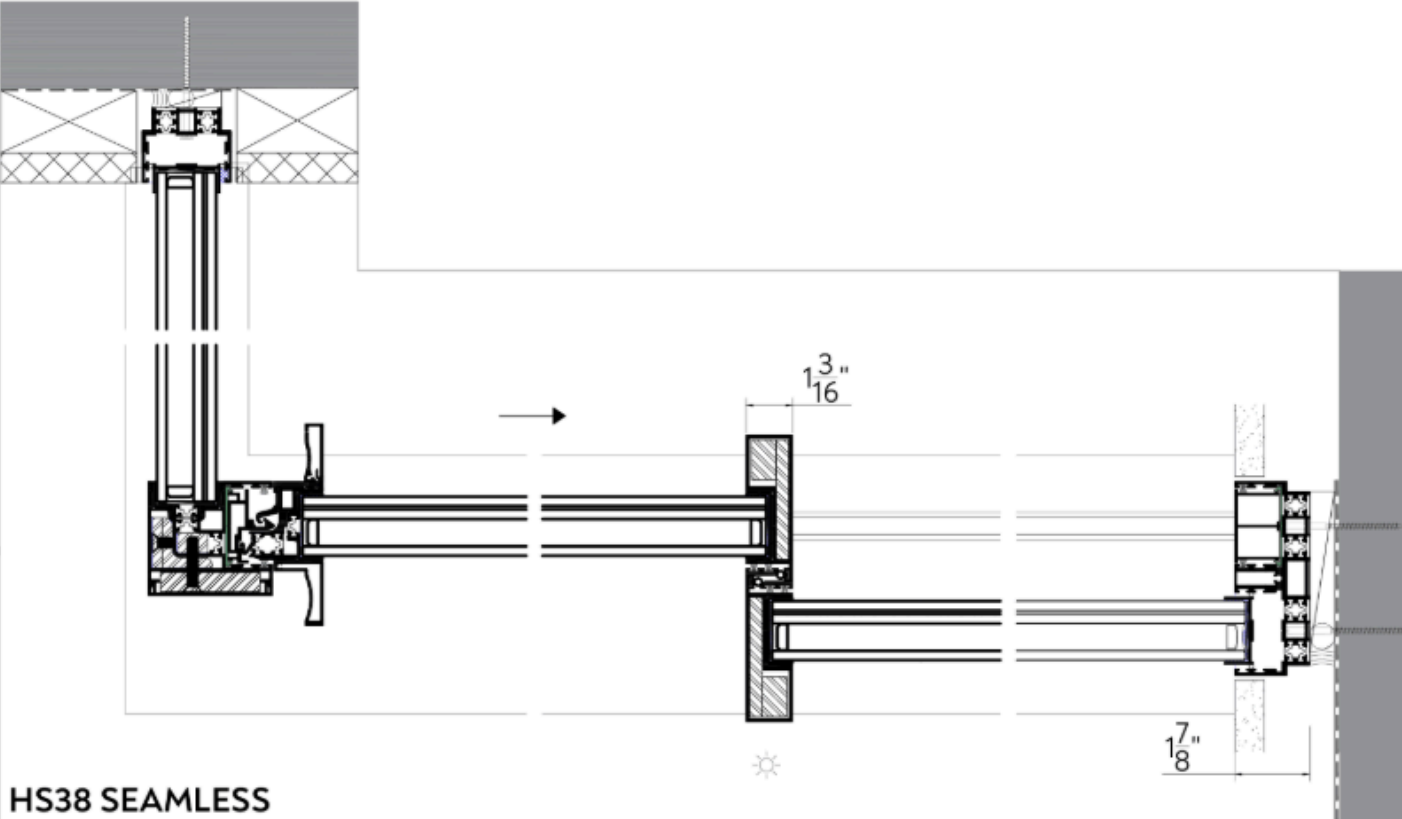

HS38 SEAMLESS
 HURRICANE RATED SLIDING DOOR, PANELS UP TO 6' X 12' AT A DP65

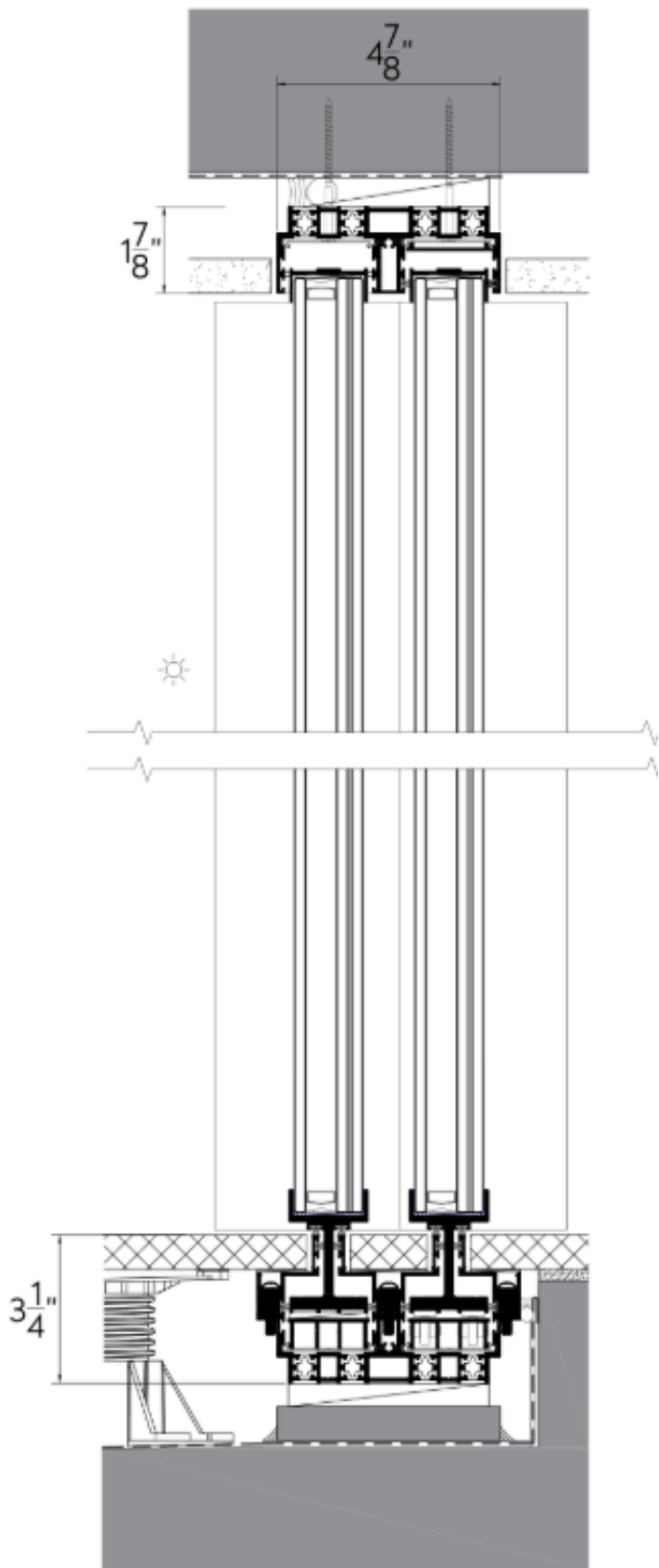

GLASS TYPE

- Double laminated IGU with SGP interlayers and Low-E energy coatings.

FEATURES

- Invisible lock.
- Fully automated options.
- Available in sliding and pocketing configurations.







QUALIFIED CONFIGURATIONS

TRACK QUANTITIES	Unlimited
MAX. PANEL WITH 20MM INTERLOCK	42 sq. ft. (120" max. net-frame height)
MAX. PANEL WITH 30MM INTERLOCK	75 sq. ft. (149-1/8" max. net-frame height)
NET-FRAME WIDTH (RIGHT SIDE)	8'-4 1/4" (100 1/4")
MAX. QTY. OF PANELS	12 panels at 75 sq. ft. per panel
FIXED FACADES	Yes
SLIDING DOORS WITH FIXED PANELS	Yes
SLIDING DOORS WITH ALL SLIDERS	Yes
CENTER- OPENING CONFIGURATION	Yes

CONFIGURATIONS AND SIZES

TEST SPECIMEN 1 (i7564)	XXXO, 2-Track (200-1/4" x 120")
TEST SPECIMEN 2 (l6439)	XXXXXOOO, 3-Track (584-5/8" x 144")
TEST SPECIMEN 3 (p2491)	XXO, 2-Track (218-3/8" x 149-1/8")
LARGEST TESTED FRAME AREA	585 sq. ft.
MAXIMUM ALLOWABLE FRAME AREA	877 sq. ft. (150% tested size)
LARGEST TESTED PANEL (FINISH)	6' x 12'
MAXIMUM ALLOWABLE PANEL AREA	72 sq. ft. (finish) / 75 sq. ft. (net-frame)

MATERIAL SPECIFICATIONS

FRAME PROFILES	6063-T5 / Polyamide 66 (25% Fiber)
INTERLOCK MULLIONS	6063-T5 / 304 Stainless Steel or C1018 Cold Rolled Steel
WEATHERSTRIPPING	Extruded Polypropylene with fin and without fin
GASKETS	PVC
APPROVED SEALANTS	Dow 121, 795, & 995
BEARINGS	304 Stainless Steel
GLASS OPTION 1	1-1/2" Overall = 1/4" Tempered + 11/16" Spacer + 1/4" Heat-Strengthened (H.S.) + 0.090" PVB + 1/4" H.S
GLASS OPTION 2	1-1/2" Overall = 1/4" Tempered + 11/16" Spacer + 1/4" Heat-Strengthened (H.S.) + 0.090" SGP + 1/4" H.S. 1-1/2"
GLASS OPTION 3	Overall = 3/8" Tempered + 7/16" Spacer + 1/4" Heat-Strengthened (H.S.) + 0.090" SGP + 3/8" H.S.

AVAILABLE OPTIONS

CENTER-OPENING MULLION	Reverse Interlock - Tested
INTEGRATED TRENCH DRAIN	Tested
SILL SUB-FRAME PROFILES	Tested
VERTICAL MEYER LOCK (3 POINT)	Tested
HORIZONTAL MEYER LOCK (3 POINT)	Tested
INVISIBLE LOCK + ANTI-LOCK OUT	Tested
MOTORIZATION	Testing not required
ELECTRO-MAGNETIC PIN-LOCK	Testing not required
FINISH OPTIONS	Class 1 Anodized, Standard Powder Coating, AAMA 2604 Powder Coating, and AAMA 2605 Powder Coating

HIDDEN SILL TRACK DESIGN

